

WileyPLUS with D2L

Pairing your Course and Adding in Key Links

To start using WileyPLUS with D2L you first need to ensure that your D2L Administrator has enabled the WileyPLUS app at your university. Your Wiley Representative will be able to confirm if this is available for you.

The next step is to pair your course with the correct title. This will allow WileyPLUS and D2L to communicate with each other.

Step 1:

Please contact your Wiley Representative to request your WileyPLUS Product ID.

This Product ID is specific to the title and edition of your resource and looks like this EPROF XXXXX.

Step 2:

Locate *Course Builder* within your D2L, this may be hidden in the settings menu.

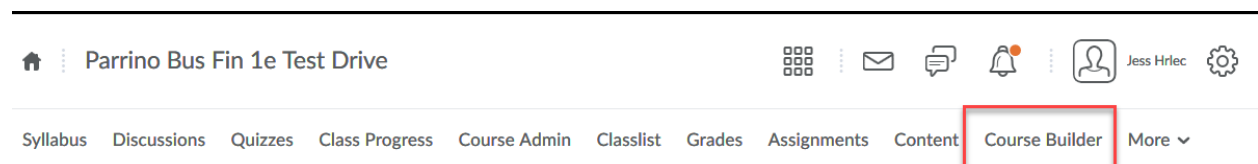

Under the add content section on the left verify that WileyPLUS icon is listed within your course. If it's not available to you, connect with your D2L administrator at the University and request the WileyPLUS app in your course.

Drag the *WileyPLUS* icon into the Module where you would like to add your link.

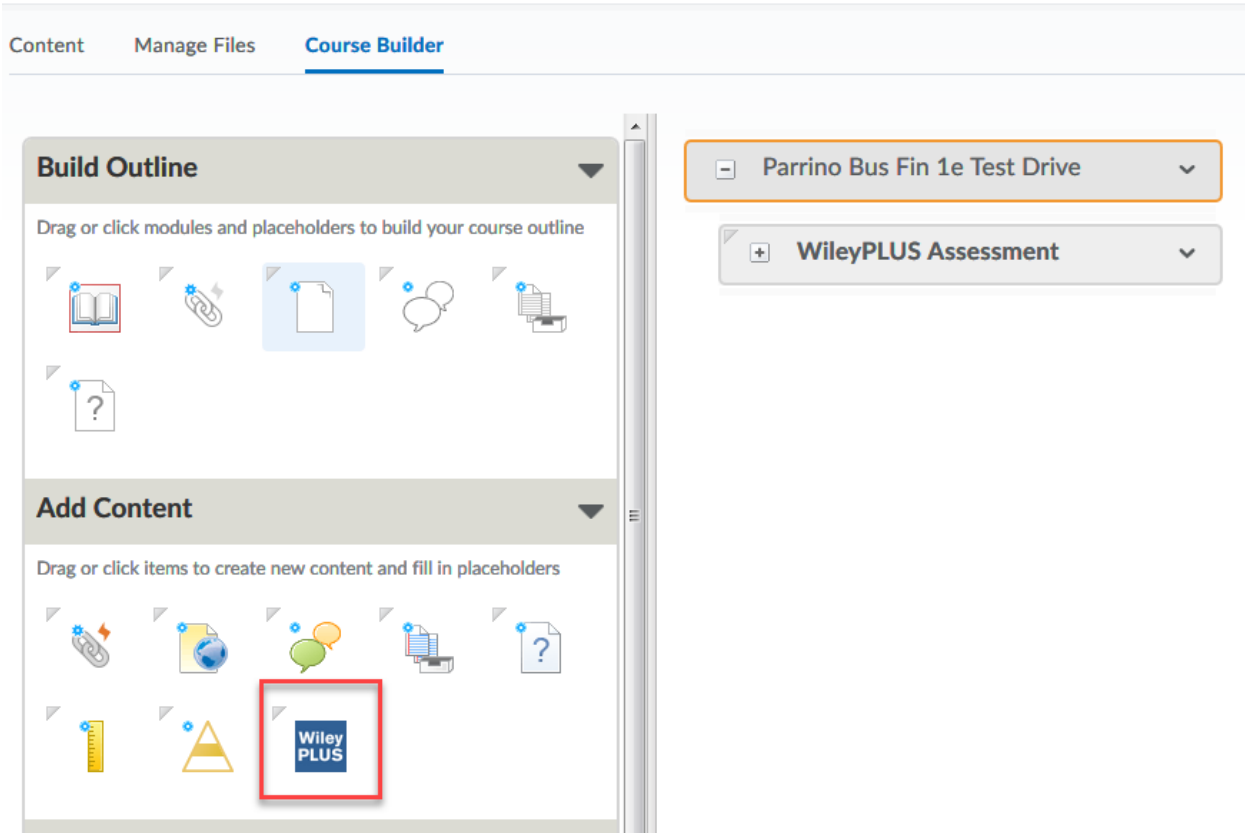

Step 3:

Enter in your Product ID and press *Submit*. Confirm that the WileyPLUS course is correct before proceeding to *Go To WileyPLUS*.

Get Started with WileyPLUS

Enter a Wiley Product ID

or...

[Contact your Wiley representative](#)

You Selected

Callister & Rethwisch, Materials Science and Engineering: An Introduction, 9th Edition, Callister

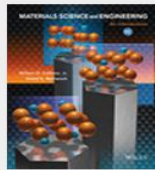

If this is correct

If not...

Enter a Wiley Product ID :

Step 4:

Choose the type of integration you would like to use – we highly recommend selecting *Deep Integration* which will allow you to provide links to specific areas in the course and assignments plus gives you a synchronization of each assignment score to the D2L Gradebook.

Selecting a *Basic Integration* allows you to add one link to the homepage of the WileyPLUS course and an optional total score sync to the D2L Gradebook.

Deep Integration

- Deep link to specific WileyPLUS assets and assignments
- Synchronize grades for each assignment automatically
- Create a highly customized course

[I want a deep integration >](#)

Step 5:

You can now begin to add WileyPLUS links to your D2L course. We recommend adding in three key links, Assignments (allowing you to view all of your WileyPLUS Assignments and edit properties), Gradebook (allowing you to view individual student grades and edit as needed) and WileyPLUS Support (providing access to the WileyPLUS Grade Refresh should WileyPLUS and D2L grades not synchronize).

Select *Instructor Tools* and *WileyPLUS*. Select *Add*.



This will add the content directly to the module link that you selected. Select the modules *Plus Sign* to see your link.

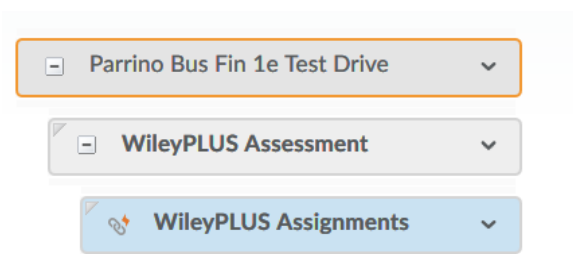

Repeat this same process to add in the WileyPLUS Gradebook and Support which are available under *Tools*

Add WileyPLUS Content

Hover on content to see more details, preview, or add content links to your course. Click the Help link for more info.

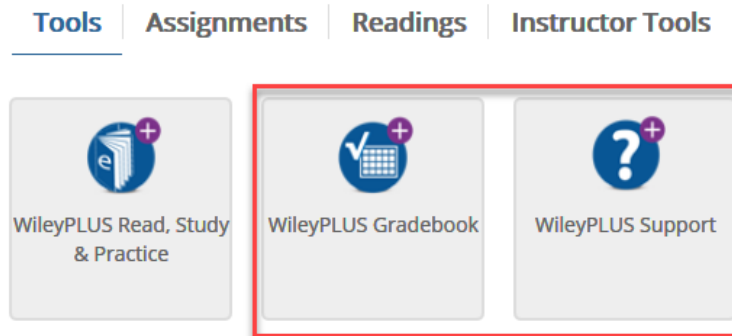

Step 6:

To ensure your WileyPLUS links are viewed in a maximum size window – making them easier to read, we recommend allowing them to open in a new tab. Navigate to your *Content* area and select the arrow drop down on your WileyPLUS links then select *Edit Properties in-place*.

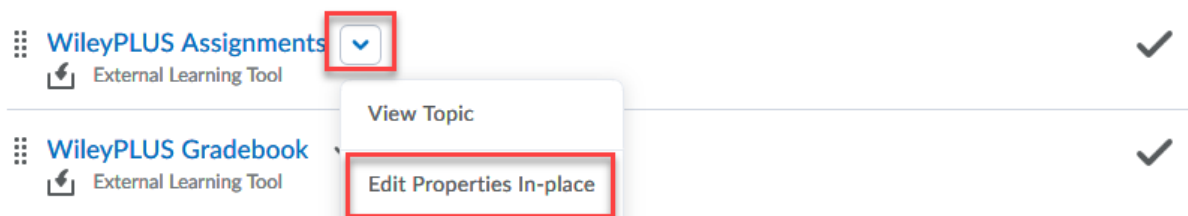

Ensure *Open as External Resource* is ticked.

WileyPLUS Assignments ▾

Published ▾ 

 External Learning Tool

Add dates and restrictions...

Tool

✓ Required: Automatic ▾

Open as External Resource

User progress is not tracked for external resources

Step 7:

Click on any WileyPLUS link to test that it has everything is working in your course.

Congratulations! Your WileyPLUS course is now paired.